

WIFI
Networks -
SLCConnect
& SLCPublic



St. Lawrence
College

This manual contains pertinent
information about SLC's WIFI
Networks – SLCConnect &
SLCPublic.

August 2021

WIFI – SLCCConnect & SLCPublic

About

Wireless Internet access is available for personal devices everywhere on campus. At SLC, we have two WIFI networks on campus. The SLCCConnect network is a secure network that you can access with the same credentials that you use to login to slc.me, the college computers, blackboard, etc. The SLCPublic network is available to everyone on campus and requires no password to login.

How to Connect

Personal Computer/Laptop

To connect your personal computer/laptop you must **select a wireless network** that your device can connect to. Click on the **connection/Wi-Fi icon** to view available network options.

Windows

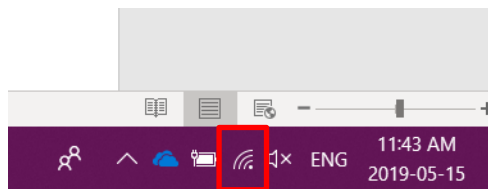

Mac

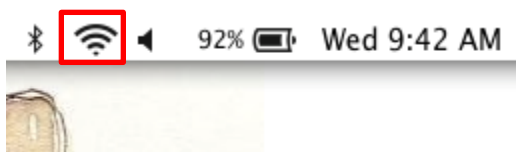

A list of available networks will pop up. **Choose the network** you would like to connect to and follow the next steps to properly connect to the *SLCCConnect* or *SLCPublic* network.

Windows

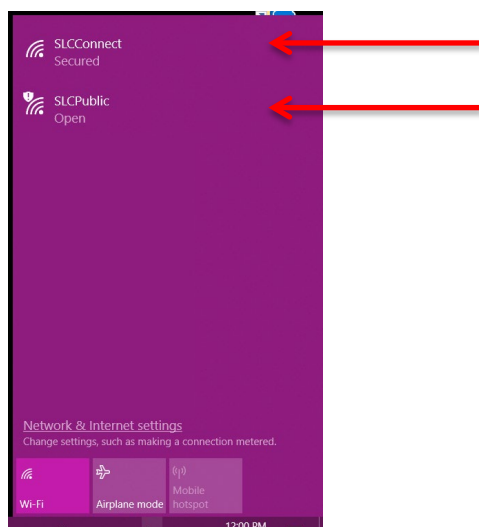

Mac

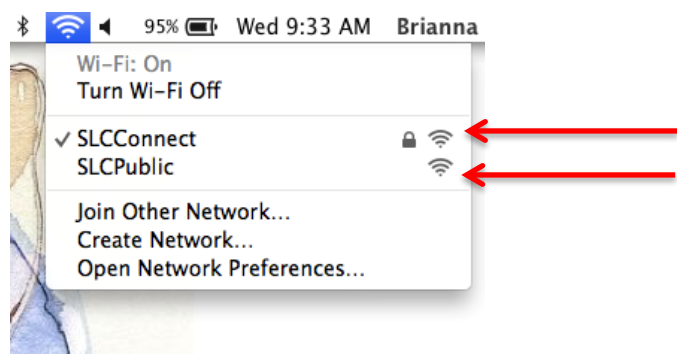

WIFI – SLCCConnect & SLCPublic

Connect to SLCCConnect: *SLCCConnect* is the college's secure network that requires a SLC account to sign in. If you select this network, you will be presented with the screen below. You will type in your full college email address (first.last@student.sl.on.ca) for the **username** and the same **password** used to sign in to slc.me, college computers, blackboard, etc. Click **Ok** or **Join** to connect.

Windows

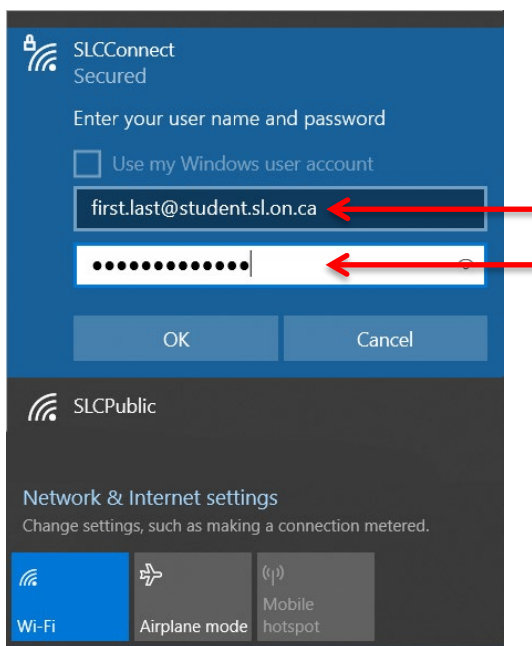

The Windows login screen for SLCCConnect is shown. It has a blue header with the SLCCConnect logo and the word "Secured". Below the header, it says "Enter your user name and password". There is a checkbox labeled "Use my Windows user account" which is unchecked. Below this is a text box containing the email address "first.last@student.sl.on.ca" with a red arrow pointing to it. Below the text box is a password field with dots and a red arrow pointing to it. At the bottom are "OK" and "Cancel" buttons. Below the login screen is a section for "SLCPublic" with "Network & Internet settings" and a link to "Change settings, such as making a connection metered." At the very bottom are three buttons: "Wi-Fi" (highlighted in blue), "Airplane mode", and "Mobile hotspot".

Mac

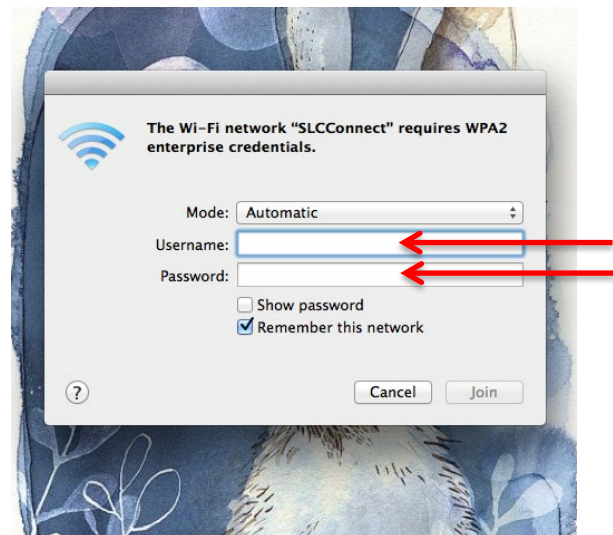

The Mac login screen for SLCCConnect is shown. It has a light gray header with the SLCCConnect logo and the text "The Wi-Fi network 'SLCCConnect' requires WPA2 enterprise credentials." Below the header is a "Mode:" dropdown menu set to "Automatic". Below that are "Username:" and "Password:" text boxes, both with red arrows pointing to them. Below the password box are two checkboxes: "Show password" (unchecked) and "Remember this network" (checked). At the bottom are "Cancel" and "Join" buttons.

Connect to SLCPublic: *SLCPublic* is the college's open network that anyone on the college campus can connect to. It does not require a username or password to log in and allows all students and visitors of the college to have an available network to connect to without an account.

WIFI – SLCCConnect & SLCPublic

iPhone/iPad

To connect your phone or tablet to *SLCCConnect* or *SLCPublic*, please follow the steps below:

Choose **Settings**.

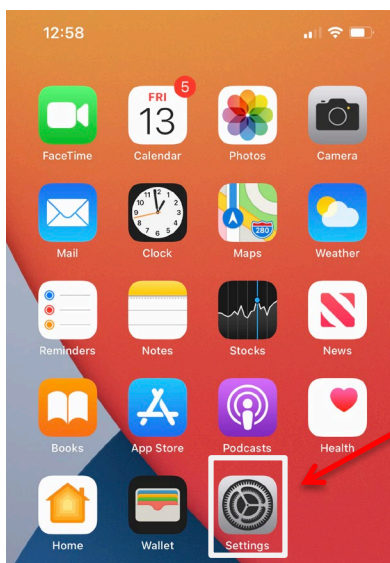

From your **Settings**, select **Wi-Fi** and then select the college network you want to connect to (**SLCCConnect** or **SLCPublic**).

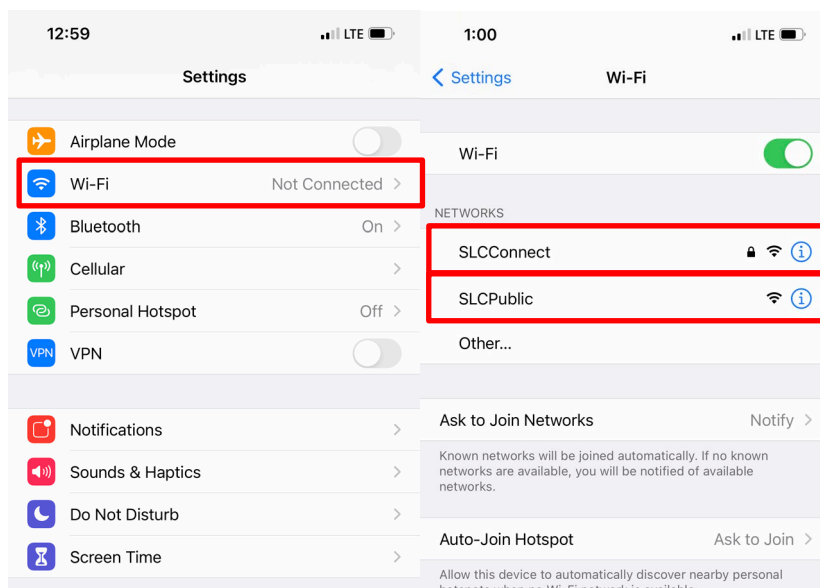

If you select **SLCCConnect** (*SLC's Secure Network*) you will be required to sign into the network with your SLC login credentials. Enter a **Username or Identity** and **password**. You

WIFI – SLCCConnect & SLCPublic

will use your college email and password to sign in that you use to sign in to slc.me, college computers, blackboard, etc. Click **Join** to connect.

You will then be shown the wireless certificate, tap **Trust**.

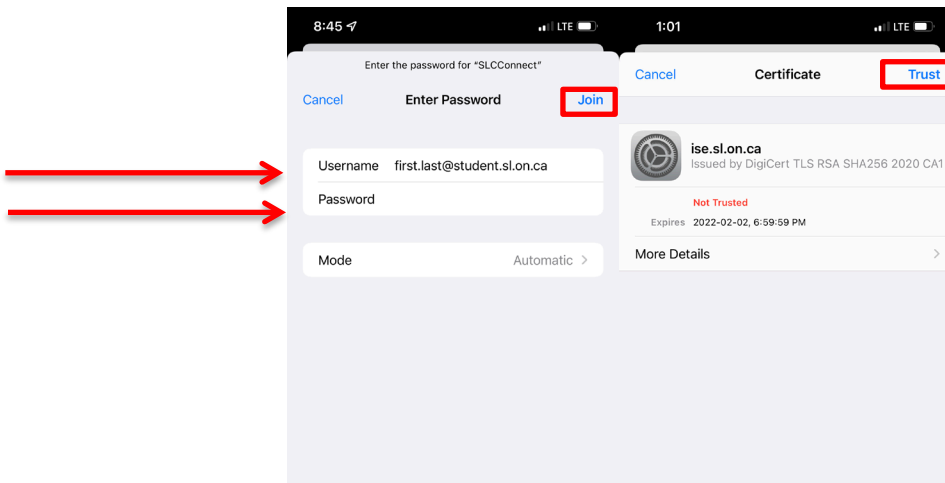

If you select **SLCPublic** (*SLC's Open Network*) follow the same steps up until the login screen. You will not be required to enter a username or password.

WIFI – SLCCConnect & SLCPublic

Android

To connect your phone or tablet to *SLCCConnect* or *SLCPublic*, please follow the steps below:

Swipe down from the top of the phone, then long tap on the **Wi-Fi icon**.

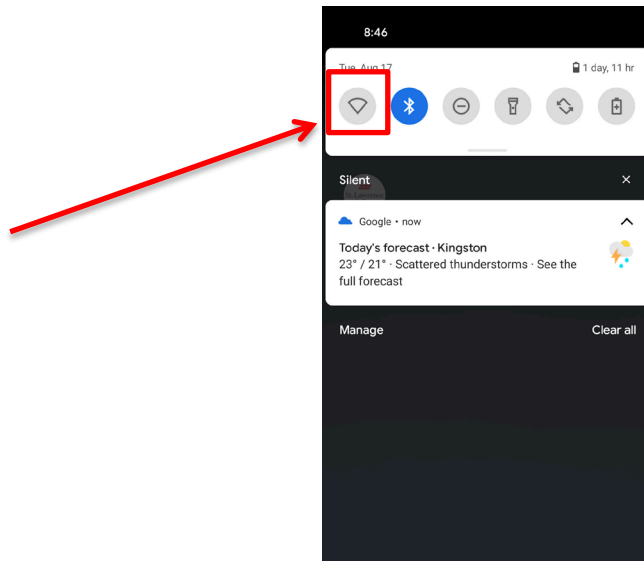

From the Wi-Fi settings menu, select the college network you want to connect to (**SLCCConnect or SLCPublic**).

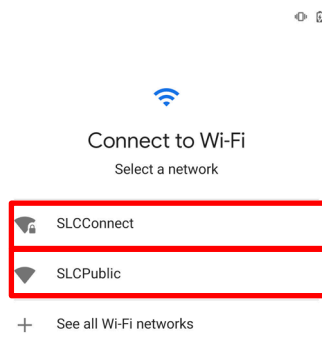

WIFI – SLCCConnect & SLCPublic

If you select **SLCCConnect** (*SLC's Secure Network*) you will be required to sign into the network with your SLC login credentials. The **Username** or **Identity** field enter your full college email address, and your **Password** used when signing into slc.me or blackboard. Depending on your version of Android you may need to type **sl.on.ca** for the **Domain** field. For the **CA certificate** or **Online Certificate** dropdown menu tap **Don't Validate**. Tap **Connect**.

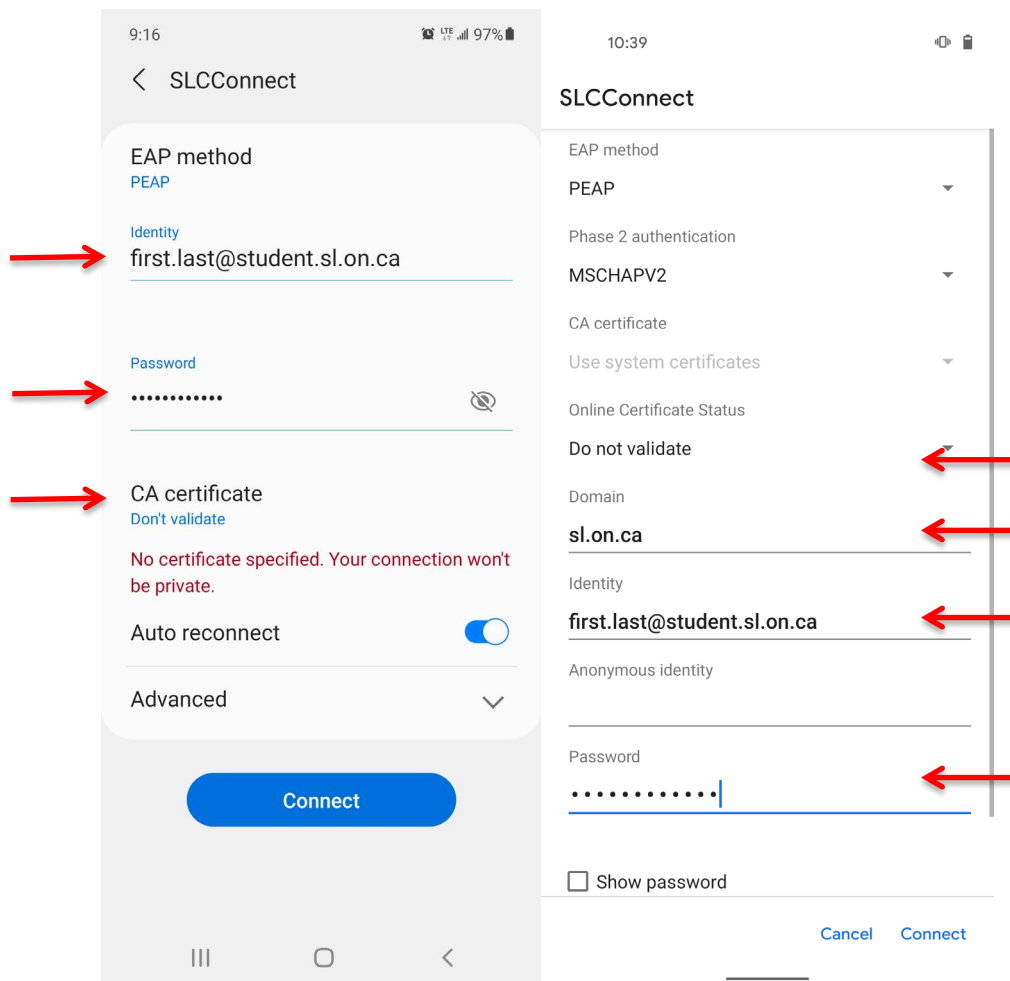

If you select **SLCPublic** (*SLC's Open Network*) follow the same steps up until the login screen. You will not be required to enter a username or password.

If you have any issues connecting to either of the SLC WIFI networks, please seek the IT Service Desk for assistance at slc.me@sl.on.ca or x1000